

VZ1.3

Raw Material:35CrMo

Grade:G80

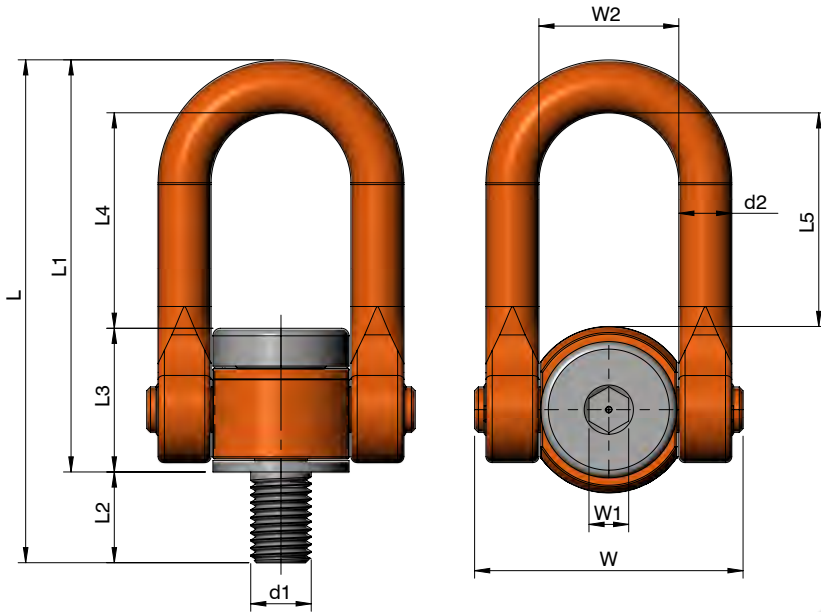

Code	WLL/T	d1	d2	L	L1	L2	L3	L4	L5	W	W1	W2	Torque Nm	Weight Kg	Stock
VZ1.3/ M8	0.5T	M8 x 1.25-6g	14	118	106	12	40	50	49	76	10.5	37	30	0.75	●
VZ1.3/ M10	0.7T	M10 x 1.5-6g	14	122	106	16	40	50	49	76	10.5	37	60	0.75	●
VZ1.3/ M12	1T	M12 x 1.75-6g	14	124	106	18	40	50	49	76	10.5	37	100	0.76	●
VZ1.3/ M14	1.5T	M14 x 2-6g	14	127	106	21	40	50	49	76	10.5	37	120	0.76	●
VZ1.3/ M16	2T	M16 x 2-6g	14	130	106	24	40	50	49	76	10.5	37	150	0.77	●
VZ1.3/ M20	3T	M20 x 2.5-6g	20	190	150	40	53	77	73	107	14.5	54	250	2	●
VZ1.3/ M24	4.5T	M24 x 3-6g	20	190	150	40	53	77	73	107	14.5	54	400	2.1	●
VZ1.3/ M30	7.3T	M30 x 3.5-6g	30	245	200	45	69	104	100	150	22.5	74	500	5.4	●
VZ1.3/ M33	8T	M33 x 3.5-6g	30	250	200	50	69	104	100	150	22.5	74	800	5.4	●
VZ1.3/ M36	10T	M36 x 4-6g	30	254	200	54	69	104	100	150	22.5	74	1000	5.5	●
VZ1.3/ M39	10T	M39 x 4-6g	30	258	200	58	69	104	100	150	22.5	74	1200	5.6	●
VZ1.3/ M42	12.5T	M42 x 4.5-6g	30	263	200	63	69	104	100	150	22.5	74	1500	5.8	●
VZ1.3/ M45	15T	M45 x 4.5-6g	30	263	200	63	69	104	100	150	22.5	74	1800	5.8	●
VZ1.3/ M48	20T	M48 x 5-6g	40	318	250	68	90	120	120	182	27.5	93	2000	11.5	●
VZ1.3/ M52	20T	M52 x 5-6g	40	318	250	68	90	120	120	182	27.5	93	2000	12	●
VZ1.3/ M56	25T	M56 x 5.5-6g	40	328	250	78	90	120	120	182	27.5	93	2100	12	●
VZ1.3/ M64	32T	M64 x 6-6g	40	340	250	90	90	120	120	182	27.5	93	2200	12.8	●

✓ - Ex-stock ● - Against Order | Ordering Example: Code - Quantity | VZ1.3/ M64 - 4 Pcs

VZ1.3
Load Configuration



Load Configuration											
	No. of Eye Bolts	1	2	1	2	2		2	2	3 - 4	
Angle Between Chain	0°	0°	90°	90°	0 - 45°	45 - 60°	Asymmetrical	0 - 45°	45 - 60°	Asymmetrical	
Code	Size	WLL(t)									
VZ1.3/ M8	M8	0.5	1	0.5	1	0.7	0.5	0.5	1.1	0.8	0.5
VZ1.3/ M10	M10	0.7	1.4	0.7	1.4	1	0.7	0.7	1.5	1.1	0.7
VZ1.3/ M12	M12	1	2	1	2	1.4	1	1	2.1	1.5	1
VZ1.3/ M14	M14	1.5	3	1.5	3	2.1	1.5	1.5	3.15	2.3	1.5
VZ1.3/ M16	M16	2	4	2	4	2.8	2	2	4.2	3	2
VZ1.3/ M20	M20	3	6	3	6	4.2	3	3	6.3	4.5	3
VZ1.3/ M24	M24	4.5	9	4.5	9	6.3	4.5	4.5	9.45	6.8	4.5
VZ1.3/ M30	M30	7.3	14.6	7.3	14.6	10.2	7.3	7.3	15.3	11	7.3
VZ1.3/ M33	M33	8	16	8	16	11.2	8	8	16.8	12	8
VZ1.3/ M36	M36	10	20	10	20	14	10	10	21	15	10
VZ1.3/ M39	M39	10	20	10	20	14	10	10	21	15	10
VZ1.3/ M42	M42	12.5	25	12.5	25	17.5	12.5	12.5	26.3	18.8	12.5
VZ1.3/ M45	M45	15	30	15	30	21	15	15	31.5	22.5	15
VZ1.3/ M48	M48	20	40	20	40	28	20	20	42	30	20
VZ1.3/ M52	M52	20	40	20	40	28	20	20	42	30	20
VZ1.3/ M56	M56	25	50	25	50	35	25	25	53	37.5	25
VZ1.3/ M64	M64	32	64	32	64	45	32	32	67	48	32

